

# SMARTACTION

COMPACT, CONNECTED,  
ACCESSIBLE.



THE COMPLETE SOLUTION FOR  
THE SMART FACTORY

 **BIESSE**



**JUNGET A/S**

# COMPACT, CONNECTED, ACCESSIBLE.

**SMARTACTION** IS THE SMART NEW  
FACTORY DESIGNED FOR LABORATORIES  
AND SMALL OR MEDIUM-SIZED  
COMPANIES APPROACHING THE WORLD  
OF DIGITALISATION FOR THE FIRST TIME.

THIS SOLUTION MAKES IT POSSIBLE  
TO CREATE A **COMPACT, CONNECTED,  
ACCESSIBLE** JOINERY WITHIN REACH OF  
EVERY PRODUCTION SET-UP, THANKS TO  
THE APPLICATION OF ALL THE FEATURES  
OFFERED BY INDUSTRY 4.0.





The machines are all connected in real time and guarantee fast, optimised production, making the whole company more competitive. SmartAction provides solutions where it's the software that leads integrated production management.

# THE COMPLETE SOLUTION FOR THE SMART FACTORY

With the complete digitalisation of processes, furnishings can be produced quickly, flexibly and with room for customisation.

**FOR THE SMALL PRODUCTION SITE, THE SMART FACTORY EXPLOITS ALL THE POWER AND EFFECTIVENESS OF HIGHLY INTEGRATED SOLUTIONS TO ENSURE PROCESSES THAT ARE STANDARDISED YET DON'T FORGO PERSONALISATION.**

- Reduced overall dimensions
- Solutions for every space requirement, with reduced labour
- Integrated management
- Optimisation of the production process
- Minimum investment
- Easy management and learning, even for less experienced operators
- Reduced consumption and Eco Saving



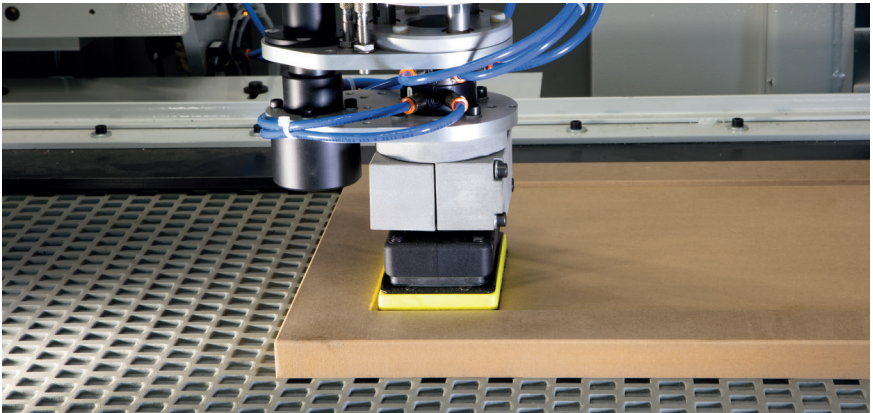

# INTERCONNECTED MACHINES

**INTERCONNECTED MACHINES, THANKS TO THE SMARTCONNECTION SOFTWARE THAT COMMUNICATES WITH ALL THE MACHINES IN THE COMPANY: FROM MACHINING CENTRES TO PANEL SAWS, EDGEBANDING MACHINES, BORING AND SANDING MACHINES.**



SmartAction is the Biesse solution where it's the software that leads integrated production management, enabling data exchange and processing the production reports of the various machines.



# MANAGING PRODUCTION IN A SIMPLE, USER-FRIENDLY MANNER



SmartConnection is a web-based solution that can be used by any device.



**SMARTCONNECTION IS A SOFTWARE PACKAGE FOR MANAGING JOB ORDERS WITHIN THE COMPANY - FROM THE GENERATION PHASE TO SCHEDULING AND ACTUAL PRODUCTION START-UP - IN JUST A FEW SIMPLE, INTUITIVE STEPS.**

**THANKS TO SMARTCONNECTION, THE PRODUCTION SITE MACHINES CAN BE LINKED UP TO TRANSFORM THE COMPANY INTO A 4.0 ENTITY.**

**MANAGE THE JOB ORDER**



**PLAN**



# SMART CONNECTION

Powered by Retuner



SCHEDULE

WORK



Biesse is extending SmartConnection across all geographical areas.  
To check availability in your country, get in touch with your commercial contact.

# EXTREMELY USER-FRIENDLY

## 1. JOB ORDER MANAGEMENT

Status	Prod. Order	Customer Code	Customer Name	Delivery Date	
<input type="checkbox"/> IN_PROGRESS	210920000001		Green house LTD	Oct 1, 2021	
<input type="checkbox"/> PLANNED	210920000003		Internal Order		
<input type="checkbox"/> PLANNED	210920000004		World Furniture LTD		
<input type="checkbox"/> PENDING	210921000001		Hotel Star	Nov 25, 2021	



SmartConnection, a solution that works independently from the programming software, lets you create job orders containing products and bills of materials with variations, the relative machining operations, the drawings and any necessary notes.

## 2. PLANNING

Production Order	Code	Article Code	Name	Qty	um
210921000001	210921000004		Top	10	PCS



For every job order created, the various work phases belonging to one machine, several machines or a number of assembly or quality control stations. Job orders are planned on the basis of the time needed and the resources available in the company.

### 3. CALENDAR

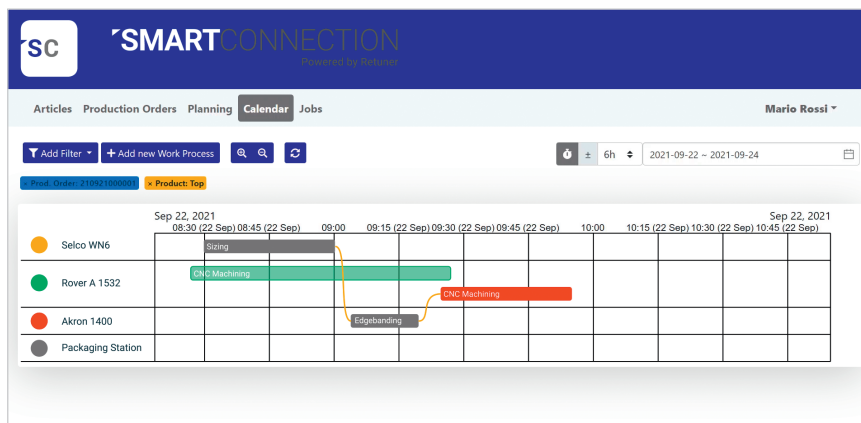

SmartConnection enables you to plan the various job order phases on the machines or manual machining stations, thanks to a calendar.

The calendar shows the link between the various phases in graphic format. If a machine/station is "occupied", the job order cannot be fulfilled and the evolving status of the machine/station is indicated.

### 4. MACHINING OPERATIONS

The screenshot shows the 'Processing' section for 'Rover A 1532'. It features a table with the following data:

Code	Phase	Status	Product Code	Product	Prod. Order	Prod. Order Status	Customer	Completion	Start
21092000003	CNC Machining	PLANNED	210920000002	Top	210920000001	IN_PROGRESS	Green house LTD	Progress bar	Sep 23, 2021
21092000004	CNC Machining	PLANNED	210920000003	Legs	210920000001	IN_PROGRESS	Green house LTD	Progress bar	Sep 22, 2021
210920000012	CNC Machining	PLANNED	210920000008	Door	210920000003	PLANNED	Internal Order	Progress bar	
210920000018	CNC Machining	PLANNED	210920000010	Shelf	210920000004	PLANNED	World Furniture LTD	Progress bar	
210920000003	CNC Machining	IN_PROGRESS	210920000008	Top	210920000003	PLANNED	Hotel Star	24% Progress bar	Sep 22, 2021



Once the part-program or configuration has been sent and the production process has been launched, the web app allows you to check the progress in real time, calculating the times, pieces and non conformities of each single machining operation.

In addition to the standard SmartConnection functions, SMARTCONNECTIONPRO also lets you:

- track the machine status, calculate the KPIs linked to production and machine use,

- add the Biesse B\_OPTI and B\_NEST optimisers, plan the stages thanks to a calendar with advanced functions based on the machining operation records,

- split and join together job orders to ensure a more efficient use of the materials and job loading in production.

# COMPACT, ACCESSIBLE 150 M<sup>2</sup> SOLUTIONS

LIMITED INVESTMENT AND EASY LEARNING, ALL WITHIN JUST A FEW SQUARE METRES.

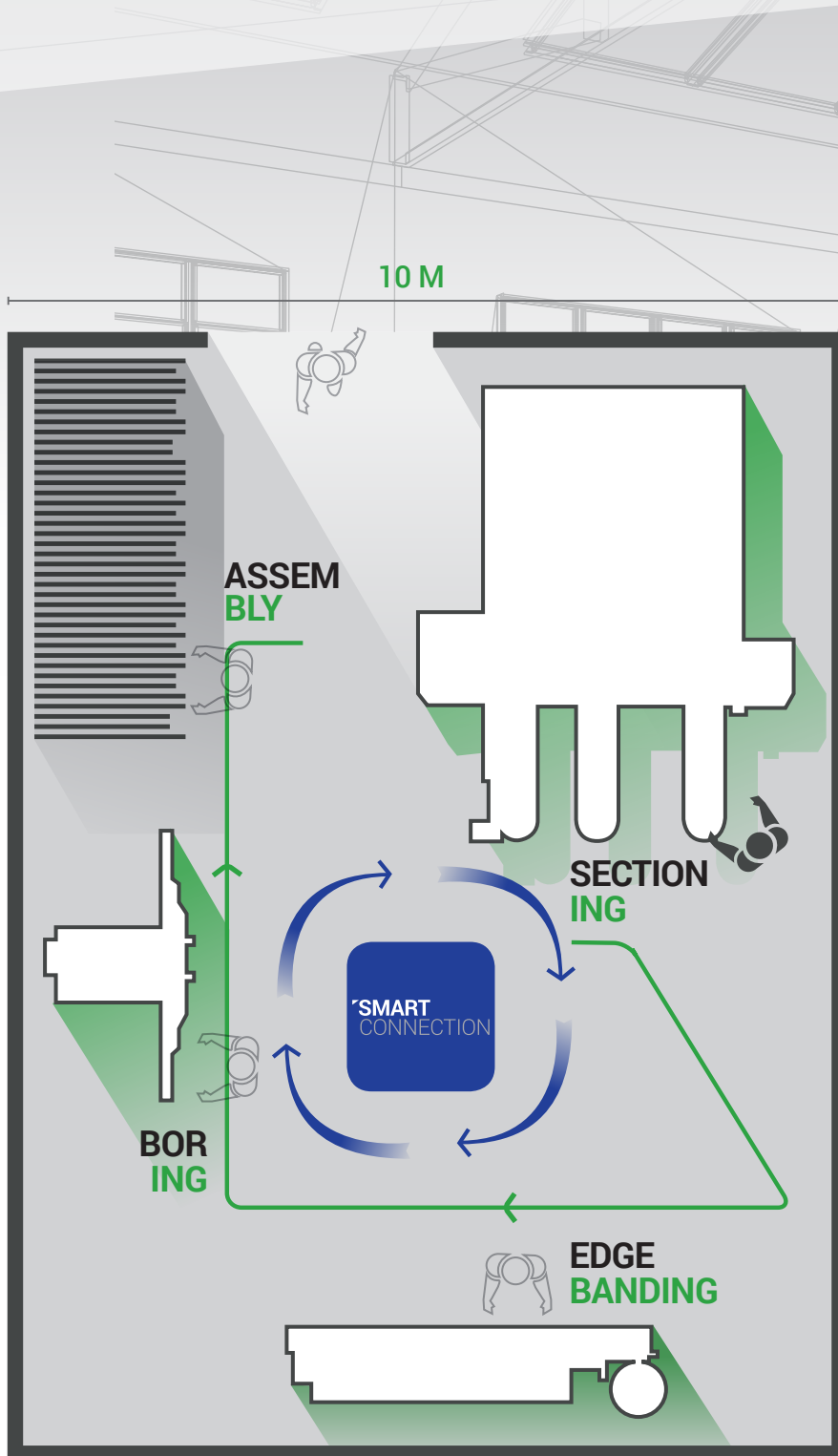

A modern laboratory starting from 150 m<sup>2</sup>, for small and medium-sized companies that produce every type of furniture item.

▶ AVERAGE DAILY PRODUCTION OF UP TO 300 MACHINED PANELS.

BIESSE TECHNOLOGIES FOR TAILOR-MADE FURNITURE OR CONTINUOUS CYCLE PRODUCTION, EVEN IN LIMITED WORKING SPACES AND WITH A REDUCED LABOUR FORCE. THE LABORATORY IS MADE UP OF THE FOLLOWING MACHINES:



## SMART CONNECTION

SMARTCONNECTION is a software package for managing job orders within the company - from the generation phase to scheduling and actual production start-up - in just a few simple, intuitive steps.

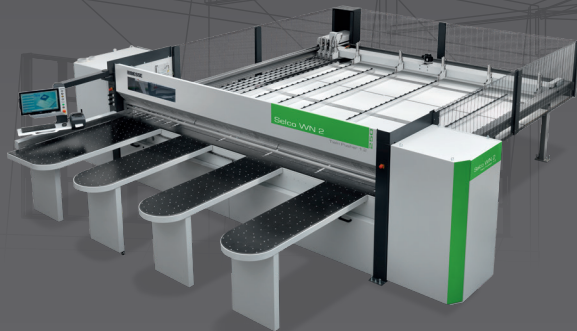

## SELCO WN 2

Selco WN 2 is the cutting centre designed for artisans who've decided to make their first investment to improve production and machining quality by switching from classic manual machinery to their first real cutting technology - reliable and easy to use, at an affordable price.



## AKRON 1300

Akron 1300 is the range of automatic single-sided edgeworking machines designed for artisans and the custom production departments of firms seeking simplicity and flexibility of use in restricted spaces.



## BREMA EKO 2.1

Brema Eko 2.1 is the compact and versatile vertical boring machine that enables formats of different thicknesses and sizes to be worked in a limited space. It's the ideal solution for "just in time" manufacturing for artisans, small companies and special production lines in large companies.

Laboratory solutions that can be personalised to suit the space and the production needs.

# COMPACT, ACCESSIBLE 300 M<sup>2</sup> SOLUTIONS

LIMITED INVESTMENT AND EASY LEARNING, ALL WITHIN JUST A FEW SQUARE METRES.

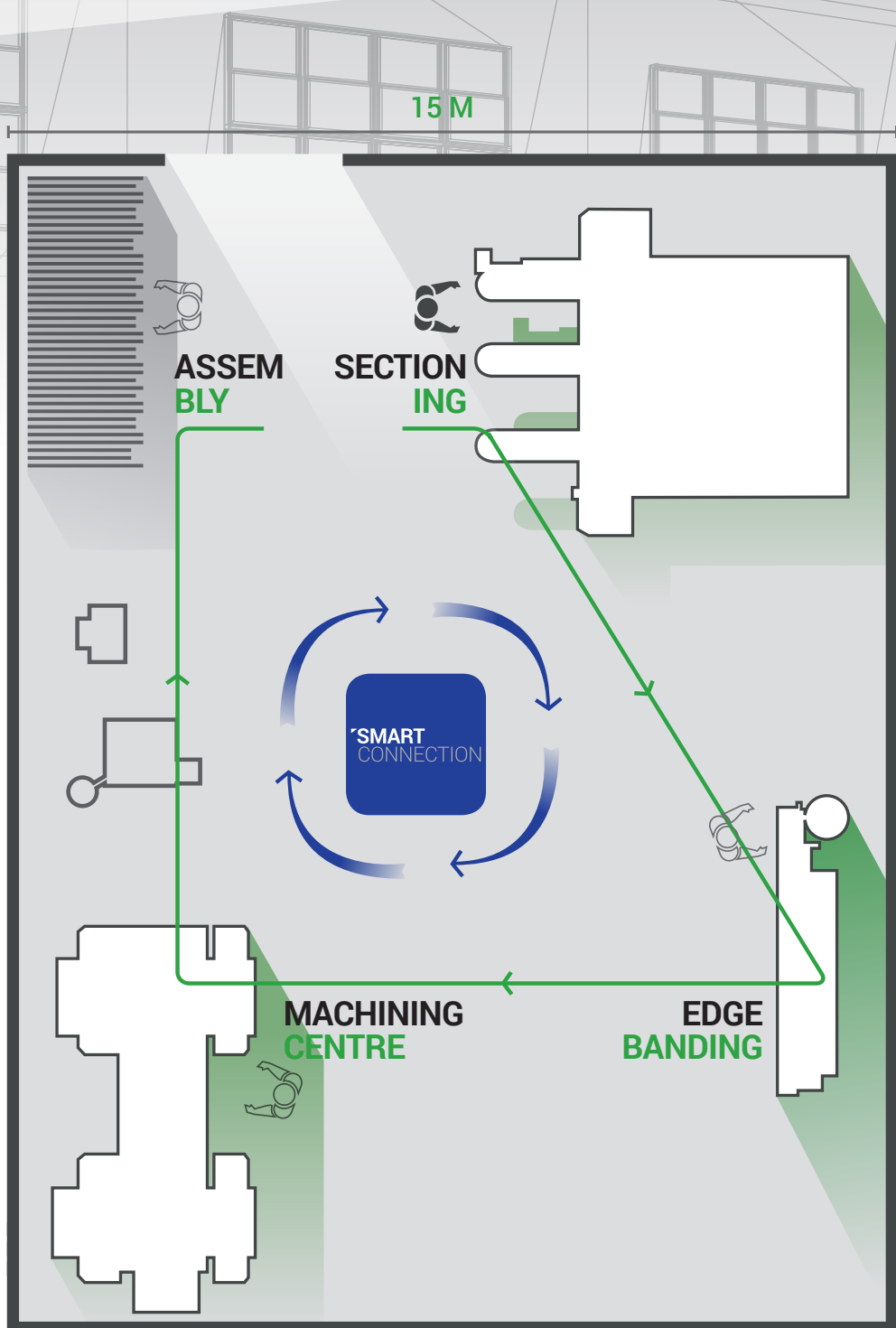

A modern laboratory starting from 300 m<sup>2</sup>, for small and medium-sized companies that produce every type of furniture item.

20 M

▶ AVERAGE DAILY PRODUCTION OF UP TO 500 MACHINED PANELS.

BIESSE TECHNOLOGIES FOR TAILOR-MADE FURNITURE OR CONTINUOUS CYCLE PRODUCTION, EVEN IN LIMITED WORKING SPACES AND WITH A REDUCED LABOUR FORCE. THE LABORATORY IS MADE UP OF THE FOLLOWING MACHINES:



## SMART CONNECTION

SMARTCONNECTION is a software package for managing job orders within the company - from the generation phase to scheduling and actual production start-up - in just a few simple, intuitive steps.

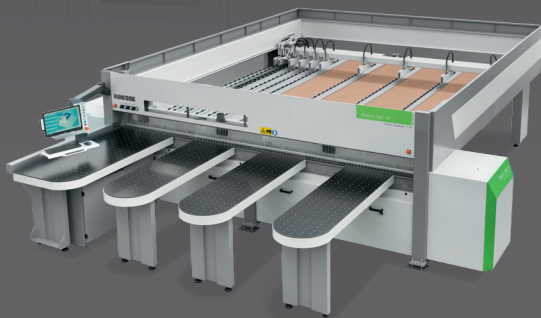

## SELCO SK 4

Selco SK 4 is the range of cutting centres designed to satisfy the needs of small to medium-sized businesses. The reduced overall dimensions and technological solutions adopted, alongside the wealth of standard equipment and user-friendly design, make Selco SK4 the new point of reference in its category.



## AKRON 1400

Akron 1400 is a range of single-sided edgebanding machines for the application of edging in rolls or strips. Compact working units designed to simplify the preparation operations are available with various configurations to suit specific production requirements.



## ROVER A 12/15/18

Rover A 12/15/18 is the new high-performing, flexible NC machining centre designed for customers who want to invest in a product that can process any item quickly and economically.

Laboratory solutions that can be personalised to suit the space and the production needs.

